

Minimum free area to be reserved test for the dryer installation.

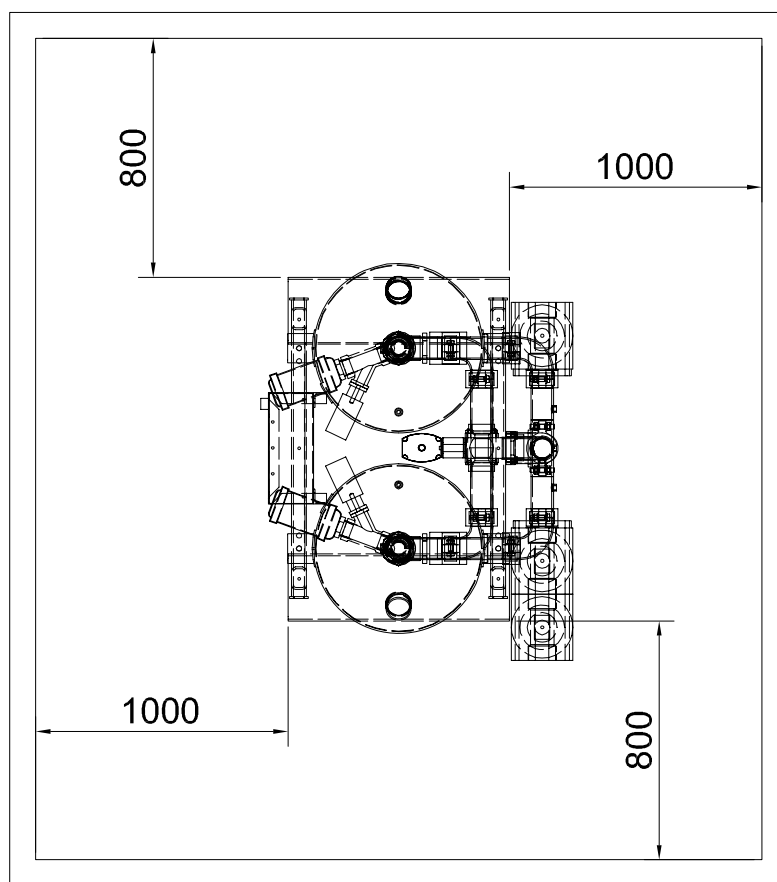

**Notes**

- All pipes should be installed stress-free to the compressor unit.
- For more information concerning air nets, cooling systems, etc refer to the compressor installation manual.
- For dimensions and air flow directions refer to the AHB dimension drawings.

The dryer unit (1) must be installed on a level floor suitable for taking the weight of the dryer. There must be a free space of 800mm around the dryer.

On both inlet filters a drain tube must be installed. The drainpipes to the drain collector must not dip into the water. For draining of pure condensate water, install an oil/water separator (Consult Atlas Copco).

The inlet filter type DD (2) for general-purpose filtration (particle removal down to 1micron with a maximum oil carry-over of 0.5 ppm). A high efficiency PD-filter (3) installed downstream the DD-filter (particle removal down to 0.01 micron and max. oil carry-over of 0.01 ppm).

An outlet dust filter type DDp (4) (particle removal down to 1micron) installed downstream the dryer. Should oil vapour and odours be undesirable, a QD carbon filter should be installed downstream the DDp filter.

It is recommended to install by-pass pipes over each filter together with ball valves in order to isolate the filters during service operations, without disturbing the compressed air delivery.

It is recommended to install pressure relief valves on each vessel of the dryer when there are ball valves installed at the inlet and the outlet of the dryer to isolate the dryers from the air net.

The installation sequence is Compressor (5)-vessel (6) -dryer. For the dryer, the hot regeneration air need to be vented out of the compressor room.

Waterseparator (7) : High efficiency waterseparator removes 90% in the compressor air when by-passing the dryer. If the WSD is not mounted in the compressor, a WSD need to be added in the installation downstream the vessel.

The drain pipes (8) to the drain collector must not dip into the water. For draining of pure condensate water, install an oil/water separator. Consult Atlas Copco.

Dit document is een afgedrukt en zal niet zonder toestemming worden gewijzigd.   
 This document is a printed and shall not be modified without the permission of the   
 copyright owner.   
 This document is not intended for manufacturing or communication to any other person or company.

01	cd100 change to cd110	2007-09-24	WH11202	
Nota	Position	Gewijzigd van Modified from	Datum Date	Ingev./Goedg. Intr./Appd.

Parent 3D Model	Ed. Version 3D
-----------------	----------------

Tolerances, indien niet aangegeven zijn volgens: Tolerances, if not indicated, according to:					
ATLAS COPCO STANDARD/Klasse/Class					
Benaming Name	INSTAL. PROPOSAL	INST.PROP.BD100-300 CD110-300	Gehelme Klasse Secrecy Class		
Materiaal Material	NOT APPLICABLE		1102 K/ 3		
Behandeling Treatment	Not Applicable		ACD		
Schaal Scale	--	Familie Family	A2	Vergeijk Compare	Eigenaar Drawing owner
Getekend Drawn by	AIR19724	Ruw nr. Blank nr.		Vervangt Replaces	All
Version Drwg	01	Ruw gew. Blank wt.	0 Kg	Afg gew. Finl wt.	0 Kg
STATUS	Des gez./chd.	Prod gez./chd.	Goedg./Appd.	Datum/Date	2007-09-24
Approved				Identificatie/Designation	Blad/Sheet ( ) 01 01
					<b>9827 7371 00</b>